

60TD-2 DECK

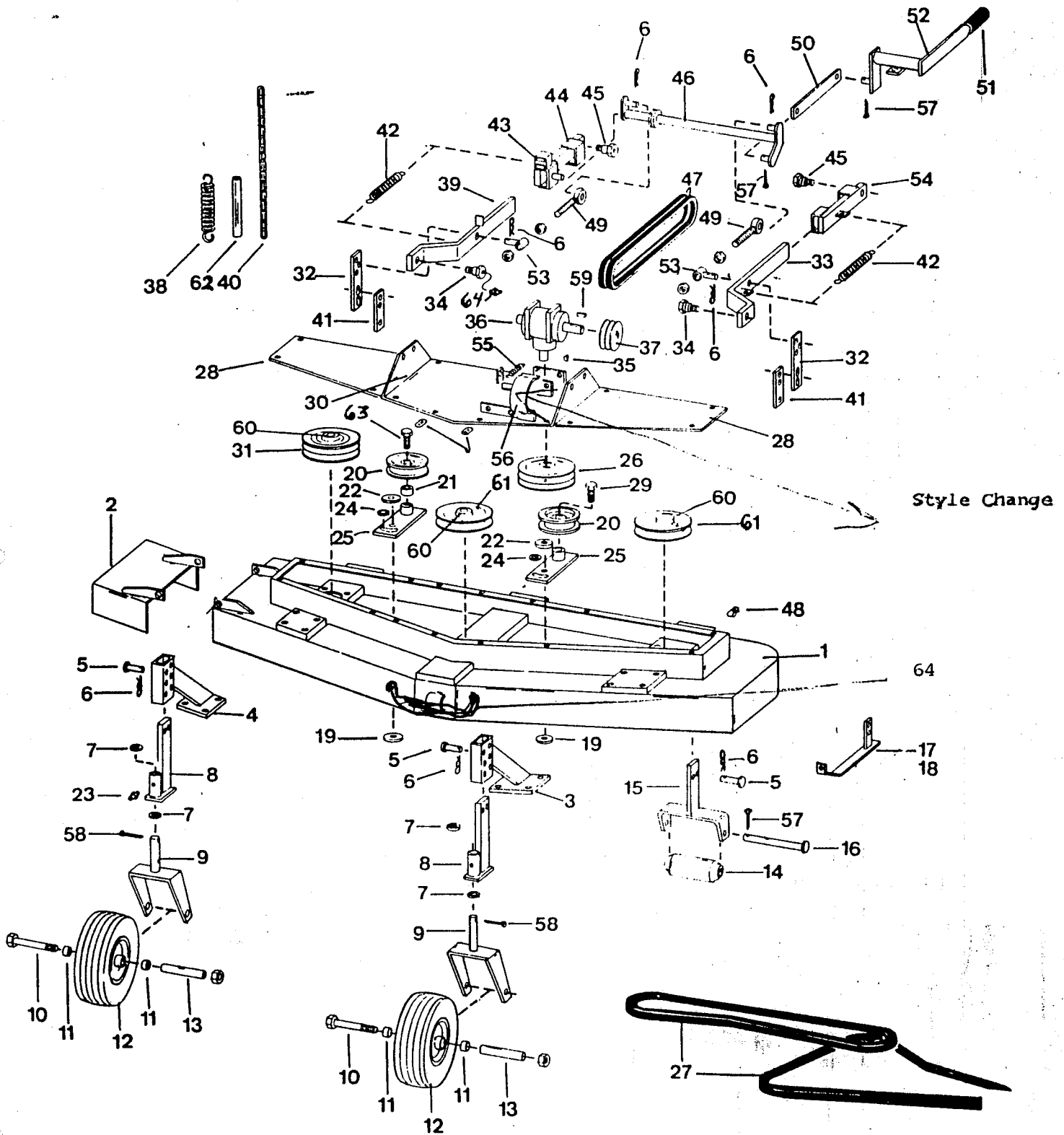

60-2 TD DECK PARTS LIST

REF. NO.	PART NO.	NO. REQ.	DESCRIPTION	REF. NO.	PART NO.	NO. REQ.	DESCRIPTION
1	400-312	1	Bare Deck	36	300-638	1	Gearbox
2	400-997	1	Foot Guard	37	400-178	1	Pulley w/Hub
3	300-332	1	L.H. Castor Wheel Arm	38	100-123	3	Deck Tension Spring
4	300-331	1	R.H. Castor Wheel Arm	39	400-944	1	R.H. Front Pusharm
5	300-203	4	Castor Arm Pin	40	400-937	1	Deck Lift Chain
6	300-202	8	Clip	41			NOT USED
7	300-195	4	Stem Washer	42	300-136	2	Clutch Tension Spring
8	300-197	2	Castor Wheel Stem	43	400-368	1	Switch Starting
9	300-371	2	Castor Wheel Fork				'85 Models
10	300-264	2	Castor Wheel Axle		400-278		Switch '84 and
11	400-234	4	Bearing				Prior Models
12	300-247	2	Castor Wheel and Tire	44	400-318	1	R.H. Rear Pusharm
	400-212		Castor Tire Only	45	300-327	2	Rear Pusharm Bushing
	400-233		Castor Wheel Only	46	300-360	1	Rockshaft
13	300-117	2	Castor Wheel Spacer	47	400-288	2	Drive Belt
14	100-132	2	Rear Rubber Roller	48	300-455	16	Fender Nuts
15	300-243	2	Rear Roller Bracket	49	100-294	2	Clutch Turnbuckle
16	300-201	2	Rear Roller Pin	50	300-353	1	Clutch Linkage
17	* 100-321	1	L.H. Anti-Skalp Skid S#C1851	51	100-114	1	Handle Grip
18	* 100-320	1	R.H. Anti-Skalp Skid S#C1851	52	300-352	1	Clutch Lever
19	300-262	2	Washer	53	300-354	2	Clutch Trunion
20	300-233	2	Idler Pulley	54	400-319	1	L.H. Rear Pusharm
21	400-928	1	Idler Pulley Spacer	55	400-153	1	Spring
22	100-188	2	Washer	56 *	400-995	1	Belt Guard (Used w/400-936)
23	300-212	2	Zerk	57	300-279	4	Cotter Key
24	300-173	5	Washer	58	200-233	2	Roll Pin
25	400-950	2	Idler Arm	59	300-289	1	Key Stock
26	400-924	1	Pulley	60	400-263	3	Hub
27	400-945	2	Deck Belt	61	400-264	2	7" Rim Spindle Pulley
28	400-951	2	Deck Shield	62	400-914	2	Sleeve
29	300-520	1	Bolt	63	300-539	1	Bolt
30	400-929	1	Gear Box Plate	**	300-212B	2	Rear Pusharm Bolt Zerks
31	400-922	1	Spindle Pulley	**	300-212B	1	L.H. Front Pusharm Bolt Zerk
32	400-947	2	Carrier Strap	**	300-212	1	R.H. Front Pusharm Bolt Zerk
33	300-629	1	L.H. Front Pusharm	64	400-998	1	Deck Handle
34	300-326	2	Pusharm Bushing Bolt	**THESE ITEMS ARE NOT SHOWN ON PICTURE			
35	300-289	1	Key	56*	Guard With Spring	400-936	

* 2 100-273 Grass Chute for Decks not extended 2060
 400-168 Was used on 1860
 * 17 100-276 L.H. Skid on 60 deck not extended to S# _____

56* Guard With Spring 400-936
 18* 100-275 R.H. Skid on 60 Deck not extended to S# _____

SPINDLE ASSEMBLY FOR 60TD-2

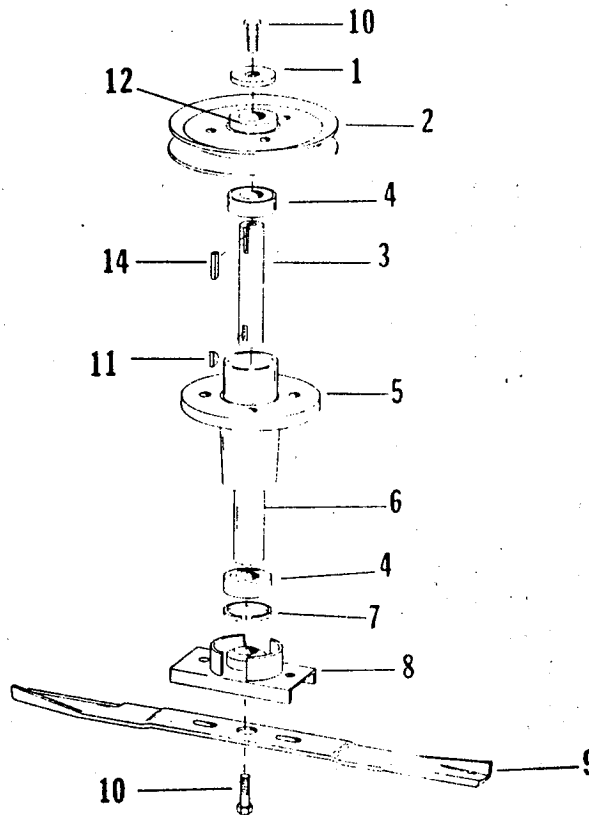

REF. NO.	PART NO.	NO. REQ.	DESCRIPTION
1	300-173	3	Spindle Pulley Washer
2	400-264	2	7" Rim Spindle Pulley
	400-922	1	R.H. Spindle Pulley
3	400-261	3	Spindle Shaft
4	300-238	6	Spindle Bearing (use on housing WITHOUT zerk)
	400-363	6	Spindle Bearing (use on housing WITH zerk)
5	400-258	3	Spindle Housing (housing WITHOUT zerk)
	400-362	3	Spindle Housing (housing WITH zerk)
6	300-253	3	Spindle Spacer (use on housing WITHOUT zerk)
	400-366	3	Spindle Spacer (use on housing WITH zerk)
7	400-257	3	Spindle Housing Snap Ring
8	400-265	3	Blade Saddle <i>see Below</i>
9	300-261	3	Blade
10	300-466	6	3/8 X 1 NF Bolt
11	400-324	6	Spindle 1/4 X 3/4 Woodruff Key
12	400-263	3	Spindle Hub
13	300-407	9	Screw for Spindle Pulley
14	300-284	3	Spindle Keystone
**	300-212A	3	Zerk

**THESE ITEMS ARE NOT PICTURED

** 8 Replaced with*

- 607